

SCHEDULE OF PUDDLE FLANGE

S.NO	DESCRIPTION	NO. OF HOLES	DIAMETER	LOCATION
1	INLET CONNECTION FROM PUMP ROOM	1	100	OUT SIDE
2	INLET CONNECTION FROM TANK	1	100	OUT SIDE
3	OUT FLOW FROM TANK TO DOMESTIC WATER TANK	1	100	OUT SIDE
4	OUT FLOW FROM TANK TO FRESH WATER TANK	1	100	OUT SIDE
5	TANK CLEAN PIPE	2	100	OUT SIDE
6	TANK VENT PIPE	2	100	OUT SIDE
7	TANK VENT PIPE	2	100	OUT SIDE

SCHEDULE OF FLANGES
AS PER IS:1538(PART IV)-1976

SL NO.	DESCRIPTION	a	b	c	NO. OF DIA OF HOLES	NO. OF DIA OF THICKNESS
1.	2500Ø PIPE	2500	355.6	406.4	12	19.1
2.	2000Ø PIPE	2000	292.1	336.6	8	19.1
3.	1500Ø PIPE	1500	228.6	279.4	8	19.1
4.	1000Ø PIPE	1000	177.8	215.9	8	15.9
5.	800Ø PIPE	800	156.1	184.2	4	15.9
6.	650Ø PIPE	650	127	165.1	4	15.9

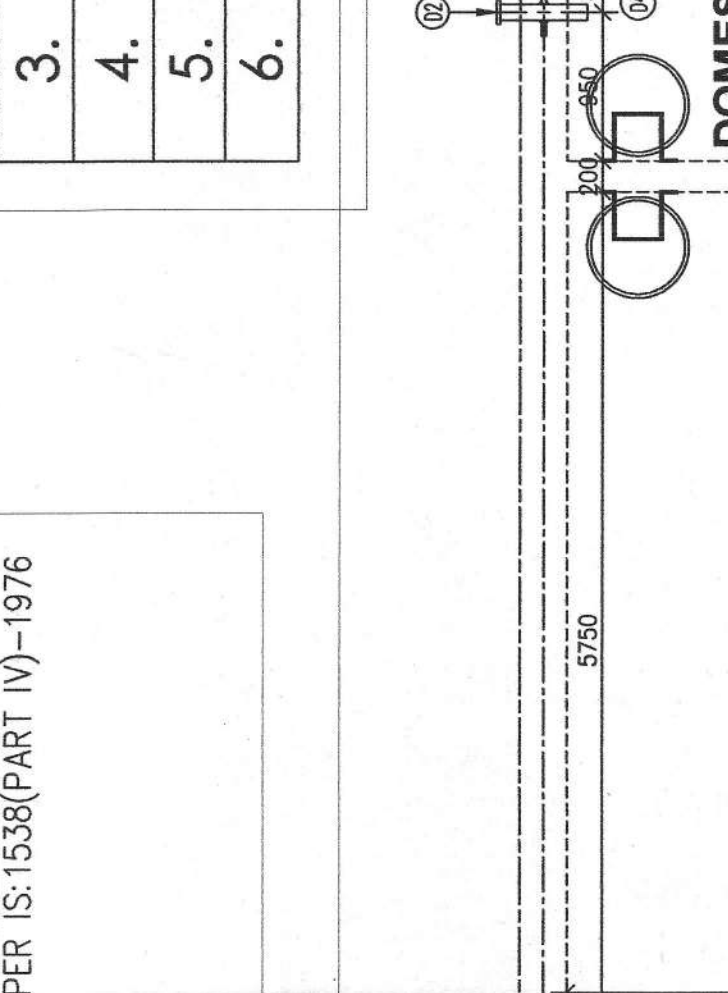
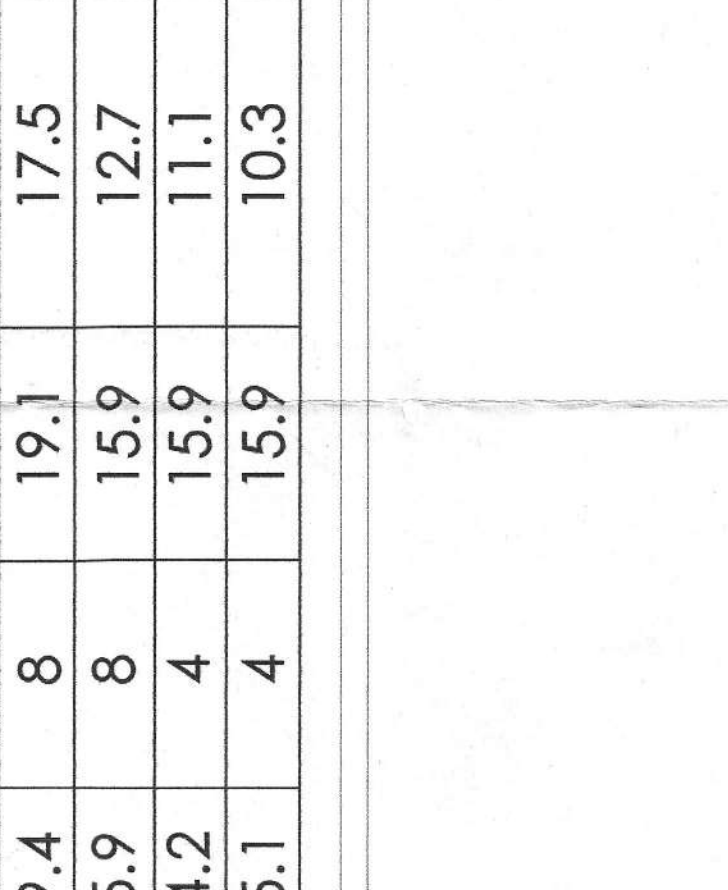
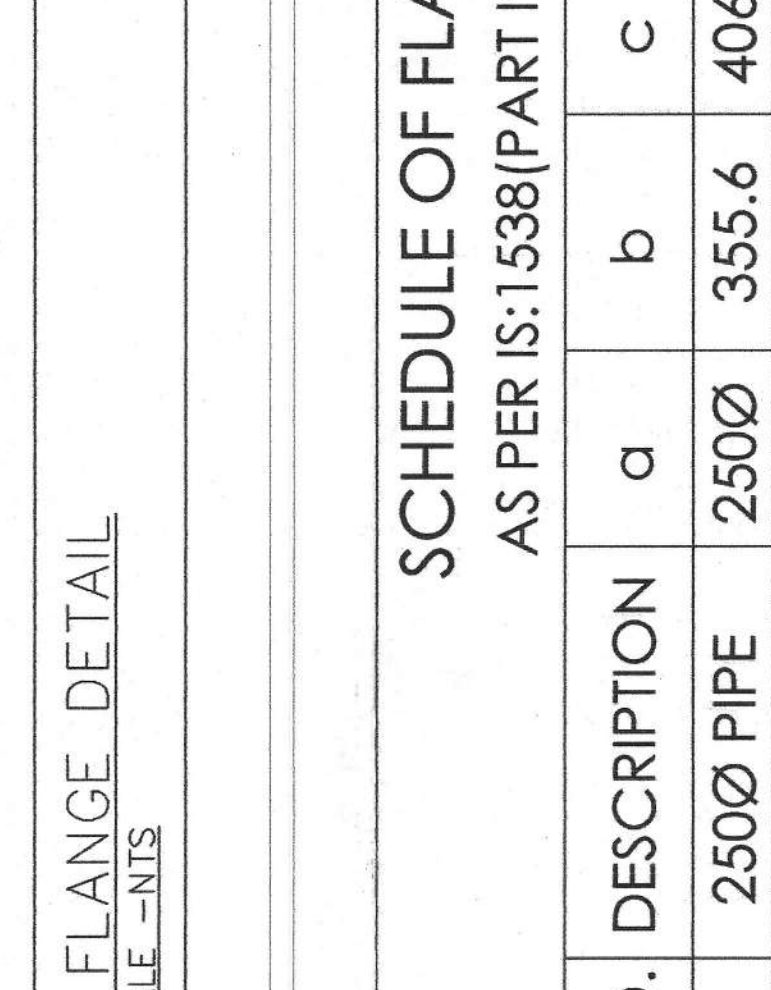
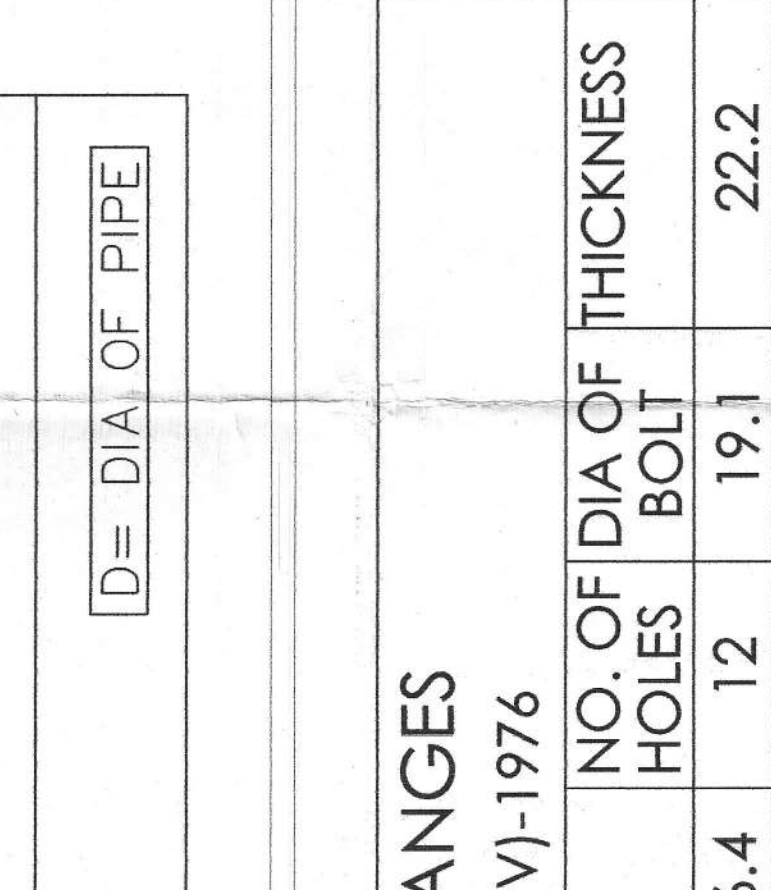

WATER REQUIREMENT
SHRISTI COMPLEX AT RAJARHAT, KOLKATA

S. No.	Apartment Configuration	No. of Room	Occupancy Per Room	Total Population	Total Water Consumption (Liter)
TOWER-1					
1	ROOM	319	1.5	478.5	107602.5
2	VISITORS	15% of Total Population	75	112.5	1125
3	MAINTENANCE	10% of Total Population	50	1250	
4	STAFF FOR HOTEL	319	1.5	478.5	11962.5
5	KITCHEN	3	Meal/person	1485.5	3887.5
6	LAUNDRY	319	7.5 kg/room/day	2392.5	83727.5
7	OFFICE STAFF	10 sq. m/person	485	9700	
8	RESTAURANT	1.5 sq. m/person	445	20025	
9	BONQUET HALL	as per ABL	1000	25000	
10	MAKE UP WATER FOR SWIMMING POOL	(Vol of Pool = 510 cum Considering 1.25% losses)			
11	FILTER BACKWASHING (40750/2400/7.5)	(Makeup Water = 6375 L/D Considering 20 mm for back washing and turnover period 6 hrs)			
TOTAL					286350
TOWER-2					
1	FLATS	83	4.5	373.5	50422.5
2	VISITORS	15% of Total Population	75	1125	
3	MAINTENANCE STAFF	10% of Total Population	50	1250	
4	STAFF	83	1.5	124.5	3112.5
5	LAUNDRY	83	7.5 kg/flat/day	622.5	21787.5
TOTAL					71697.5
TOWER-3 & RETAIL BLOCK					
1	ROOM	51	1.5	76.5	10272.5
2	VISITORS	15% of Total Population	12	180	
3	MAINTENANCE STAFF	10% of Total Population	8	200	
4	STAFF	51	1	51	1275
5	RETAIL BLOCK	10 sq. m/person	745	7450	
6	LAUNDRY	51	7.5 kg/room/day	385.05	13476.75
TOTAL					33002.25
WATER BODIES					5000
AIR WASHERS					5000
GRAND TOTAL					416956.75
LANDSCAPING 2.5 ACRE @ 20000/L/ACER					50 KLD
ROAD/PATHWAY WASHING 2.5 ACRE @ 5000/ACER					12.5 KLD

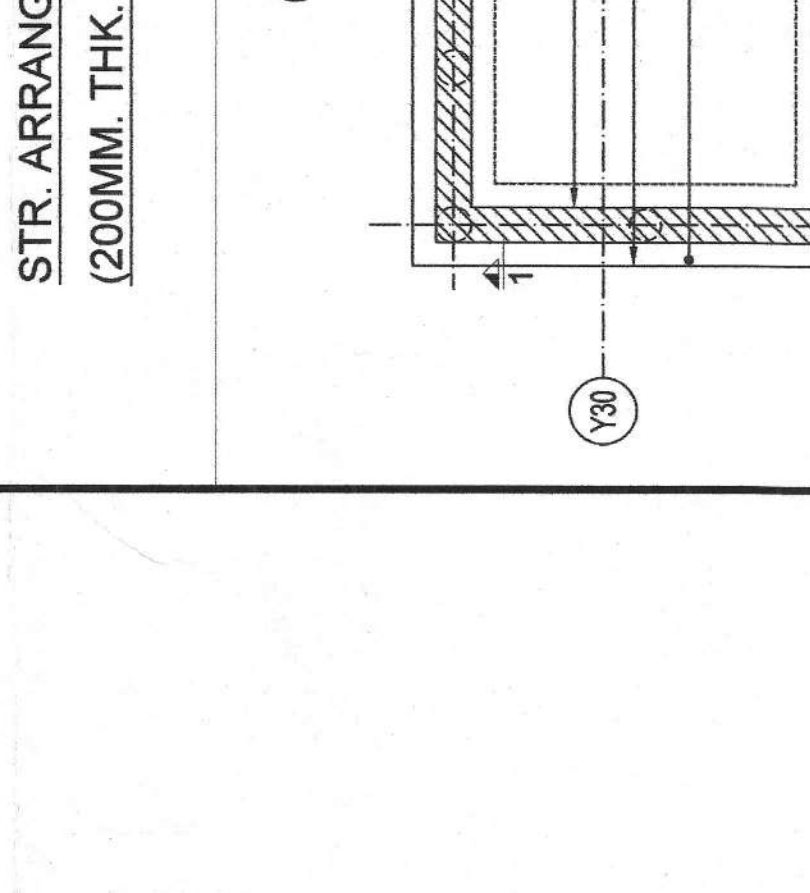
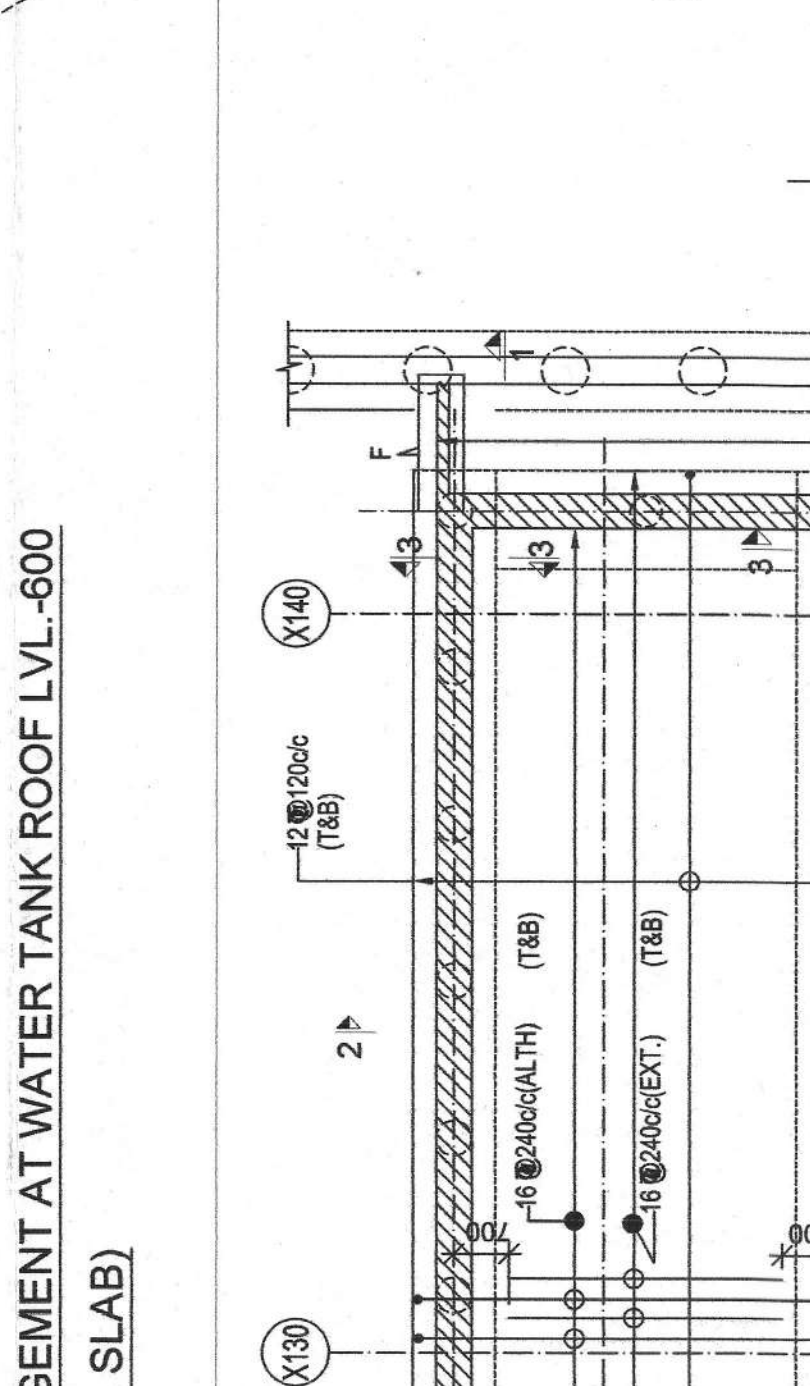
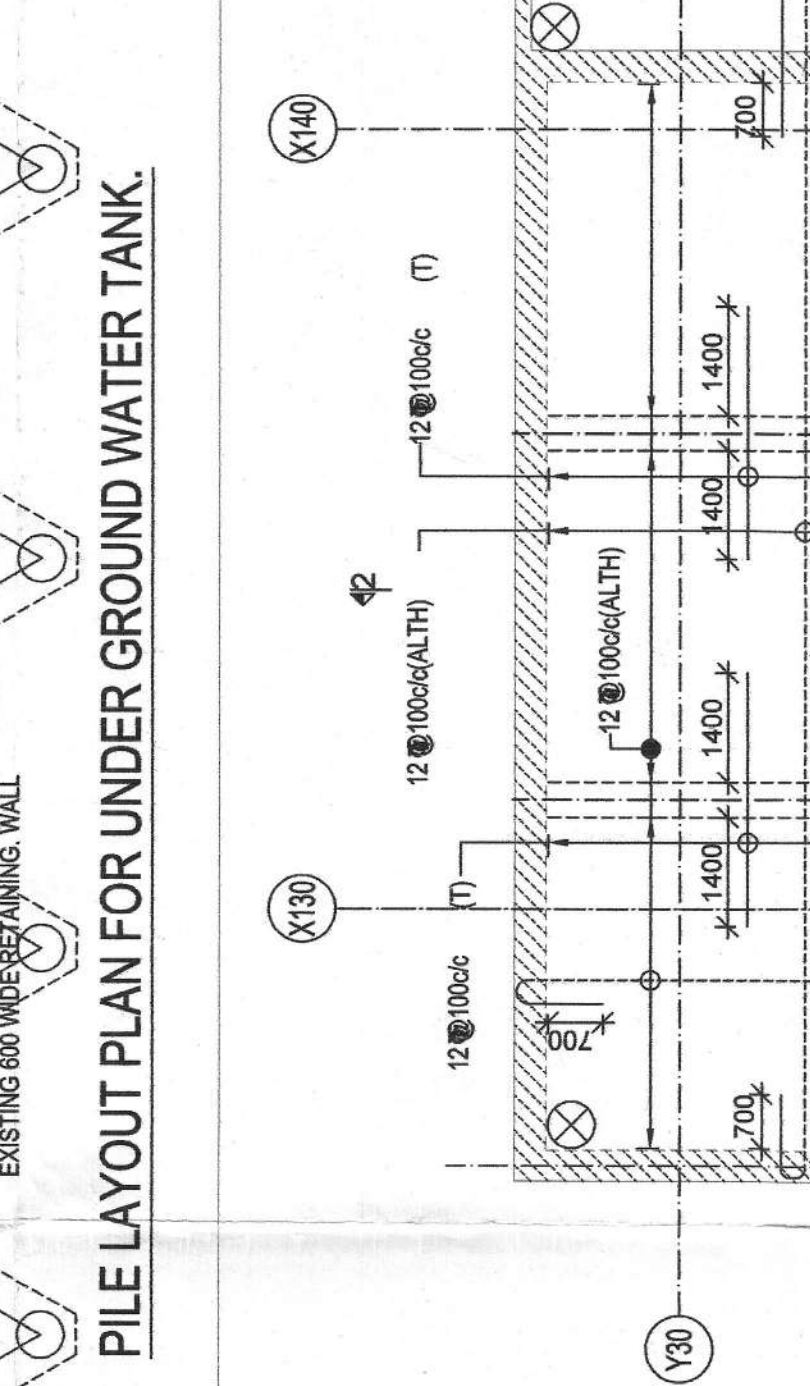
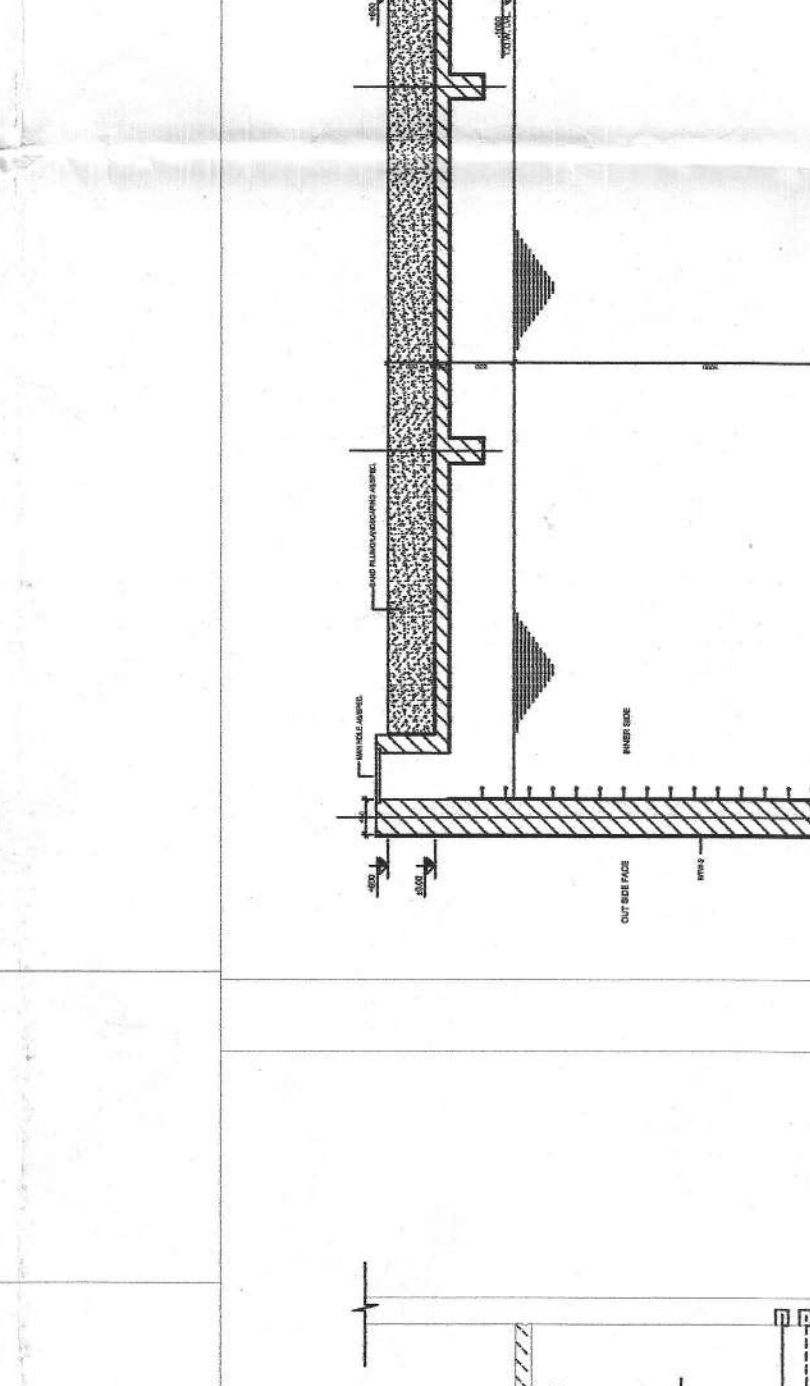
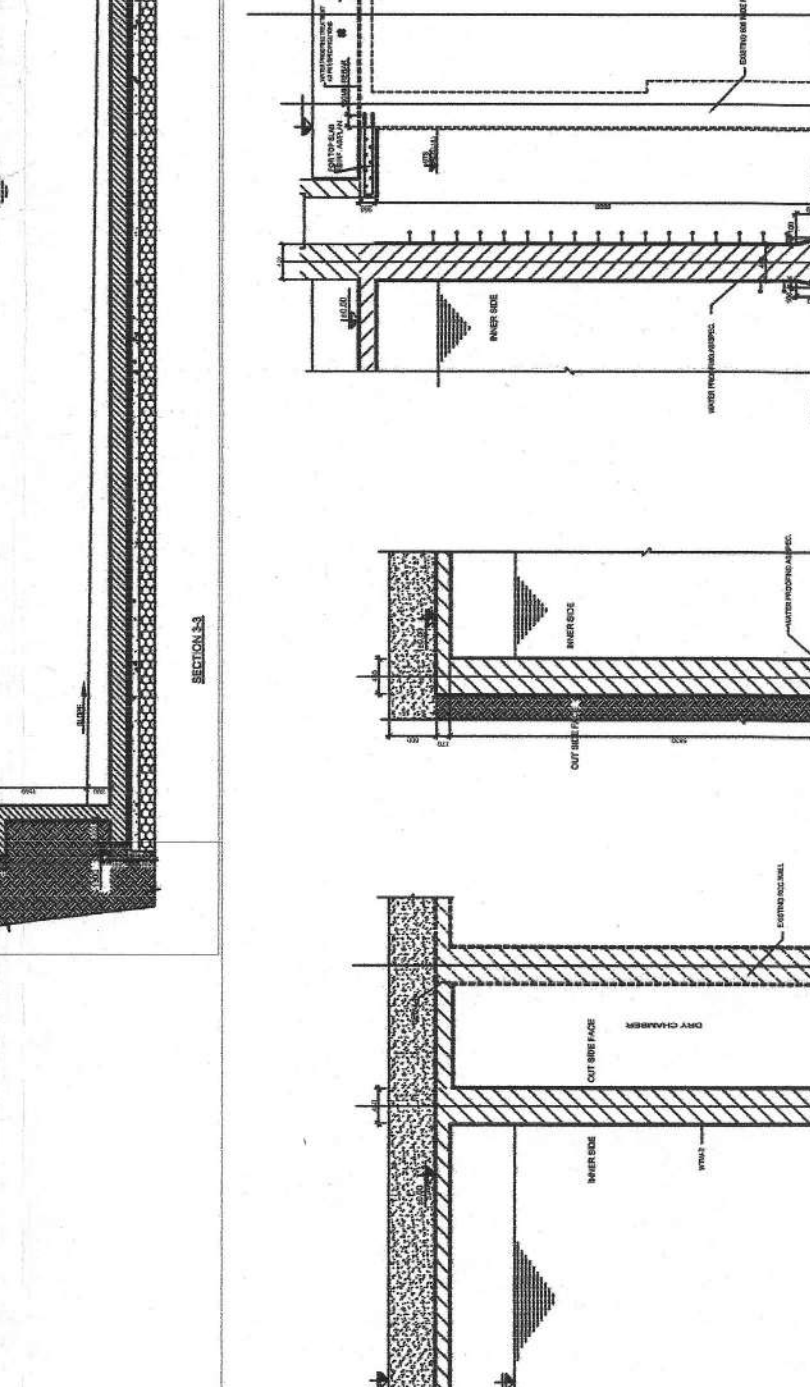
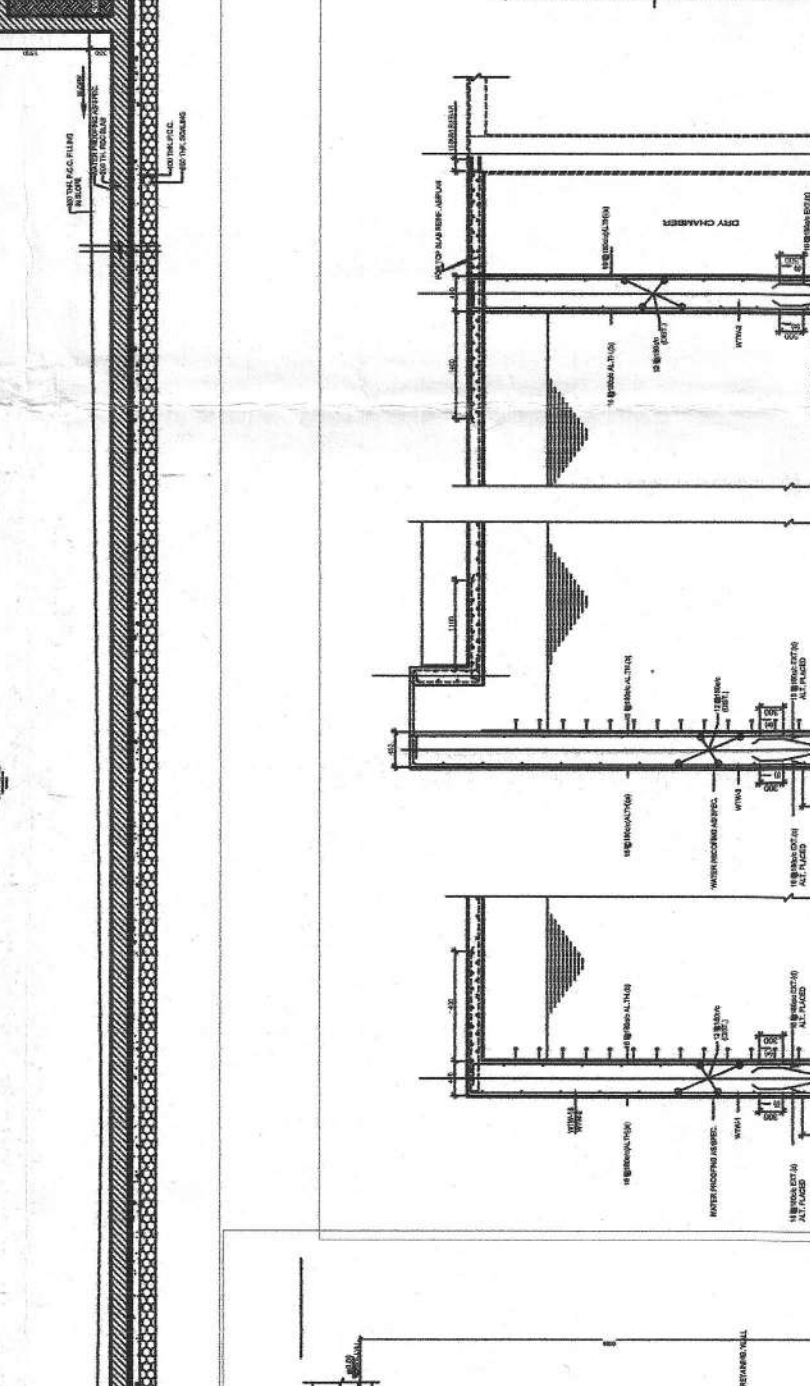
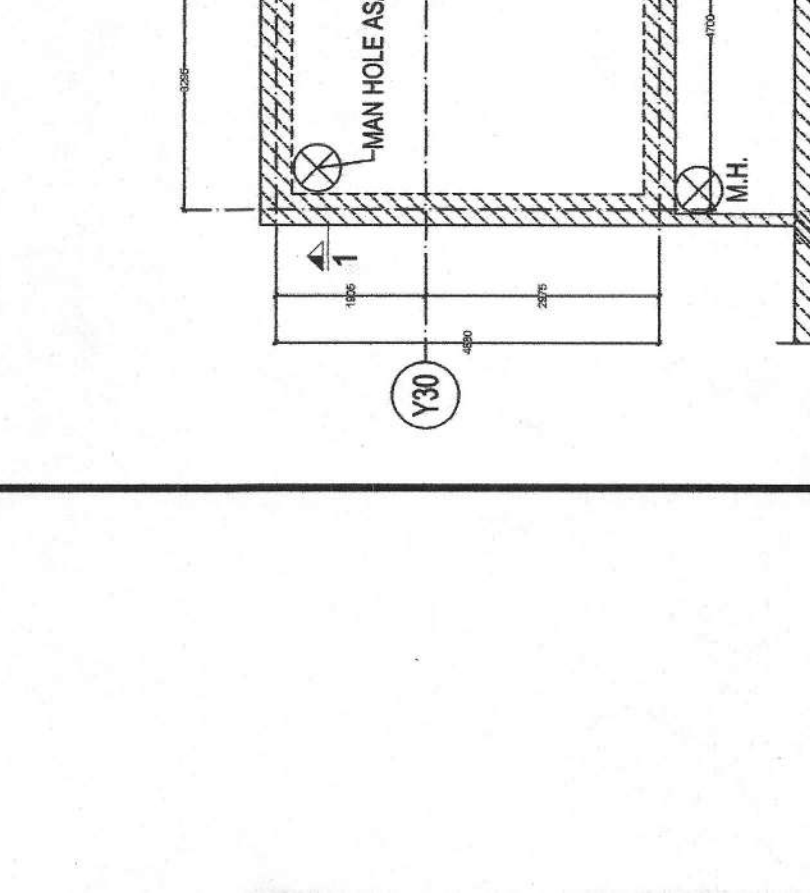
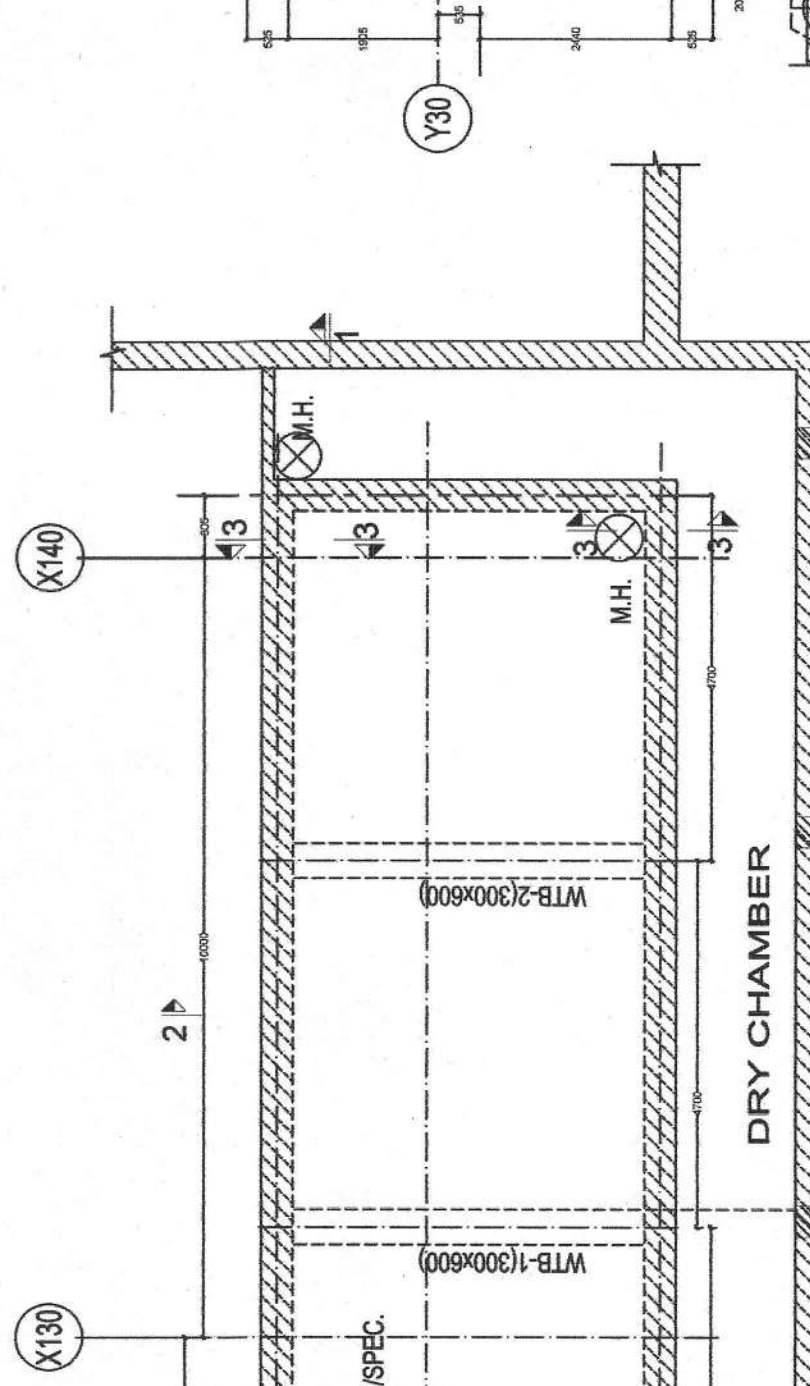
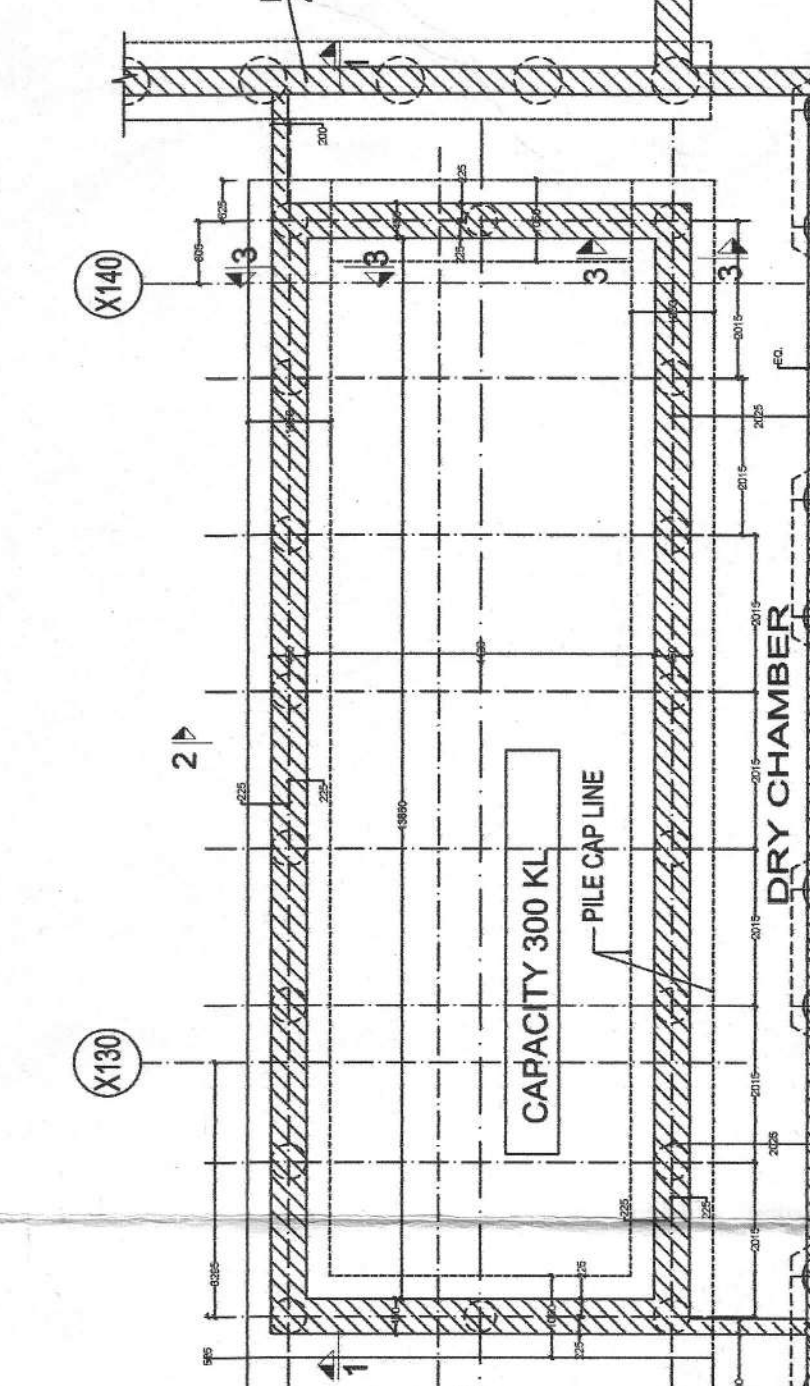
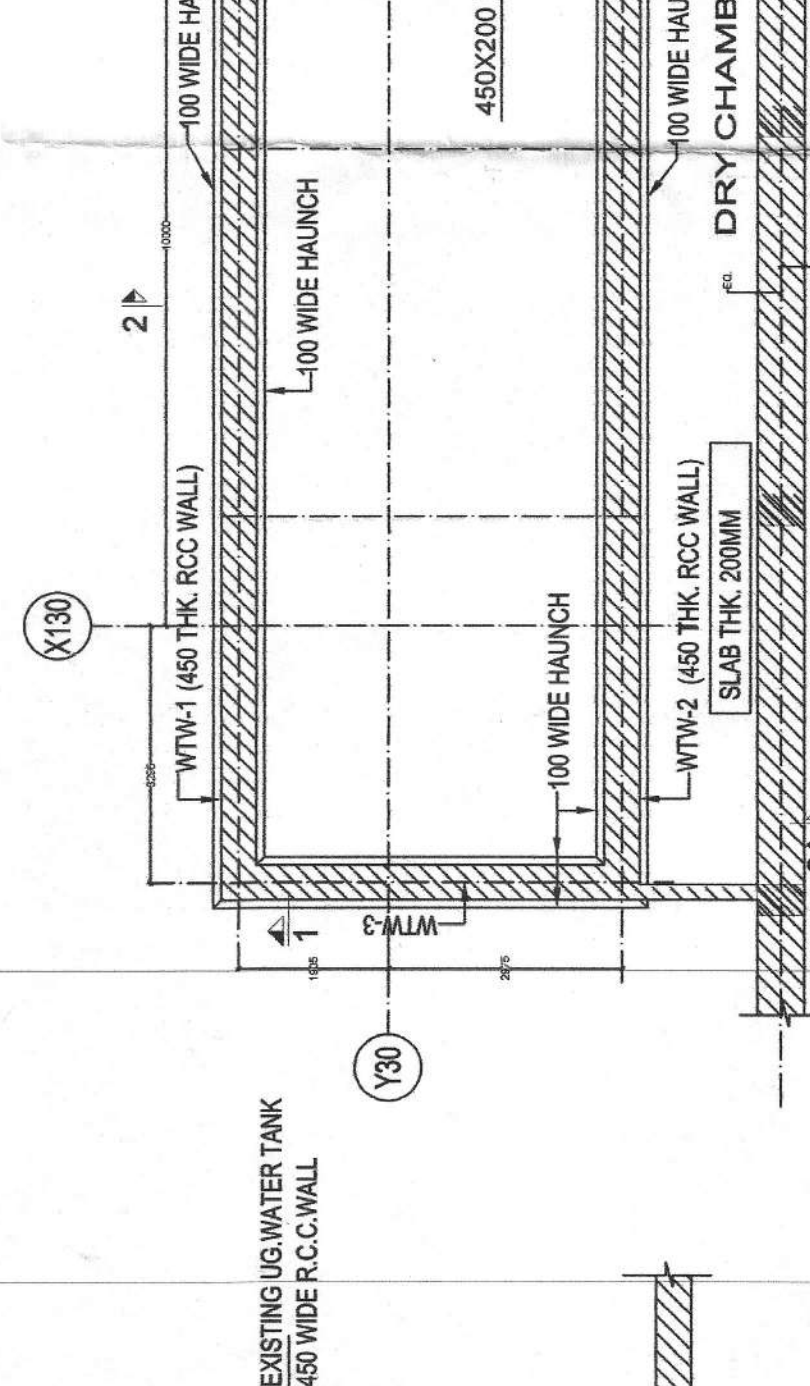
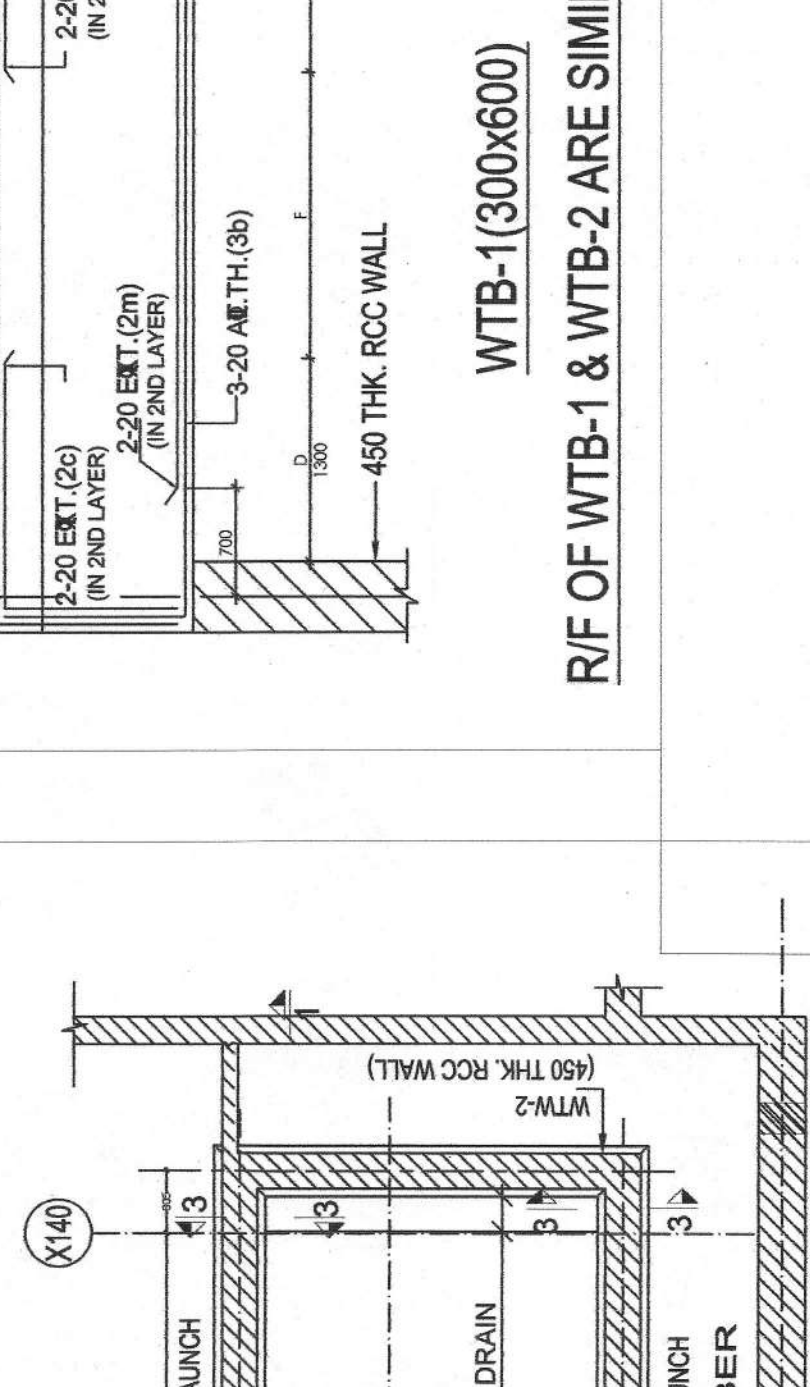
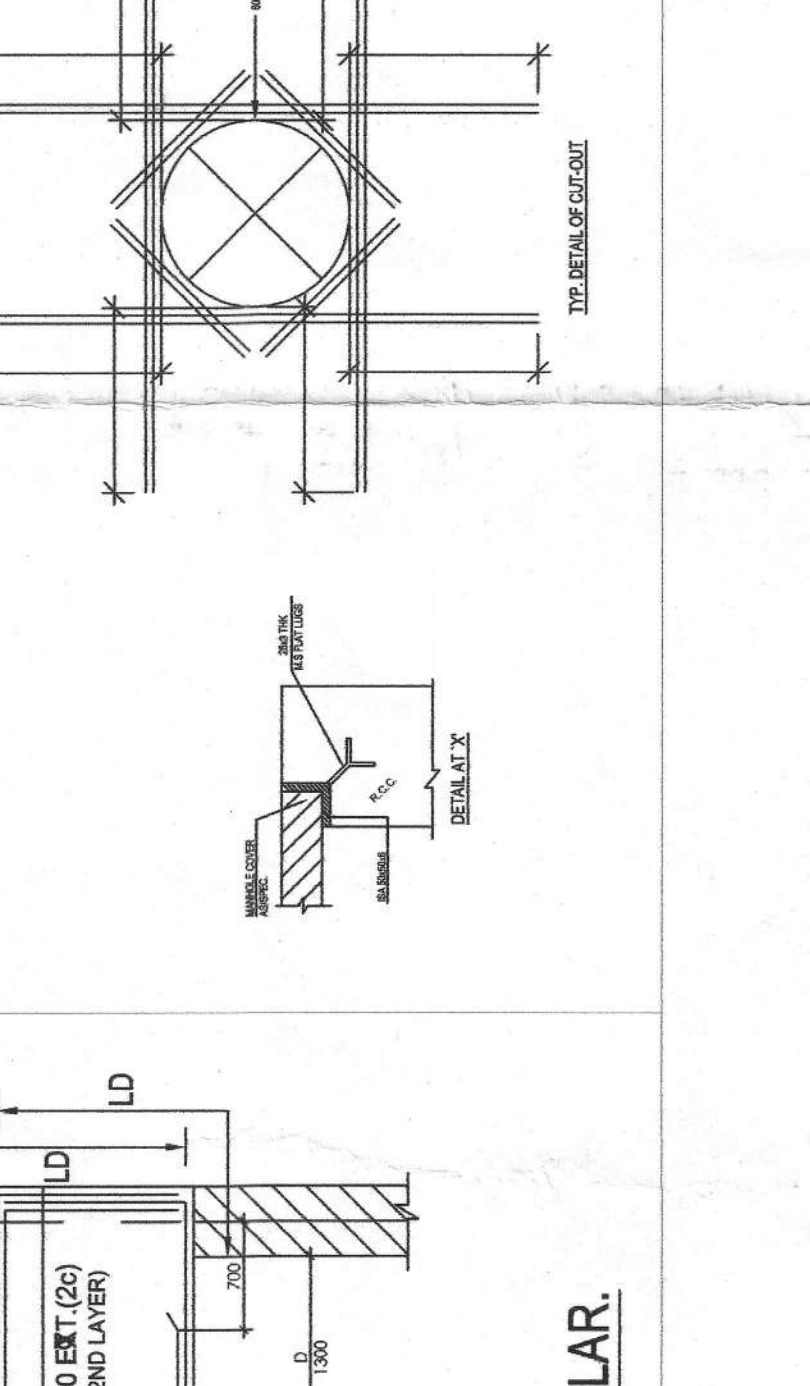
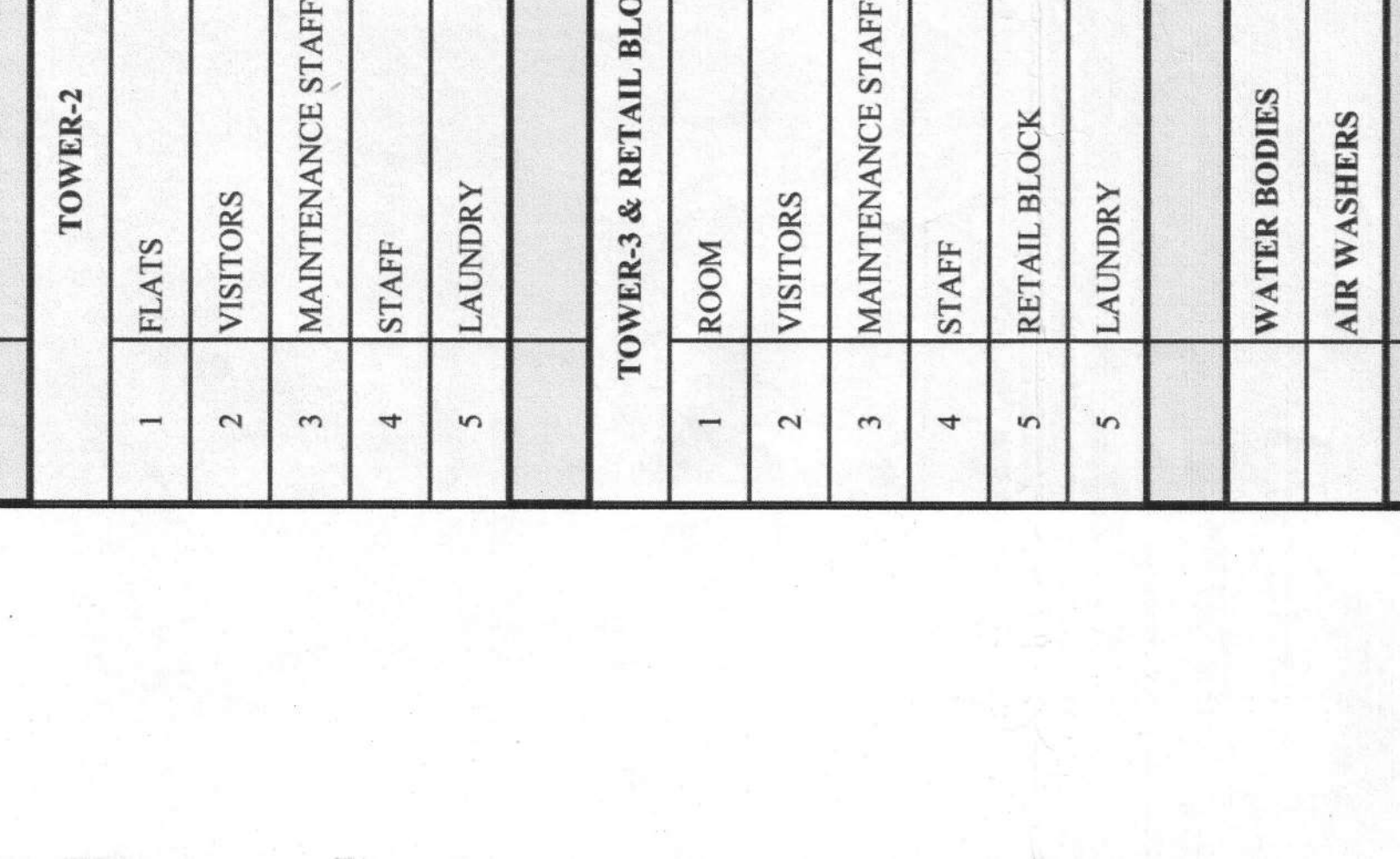
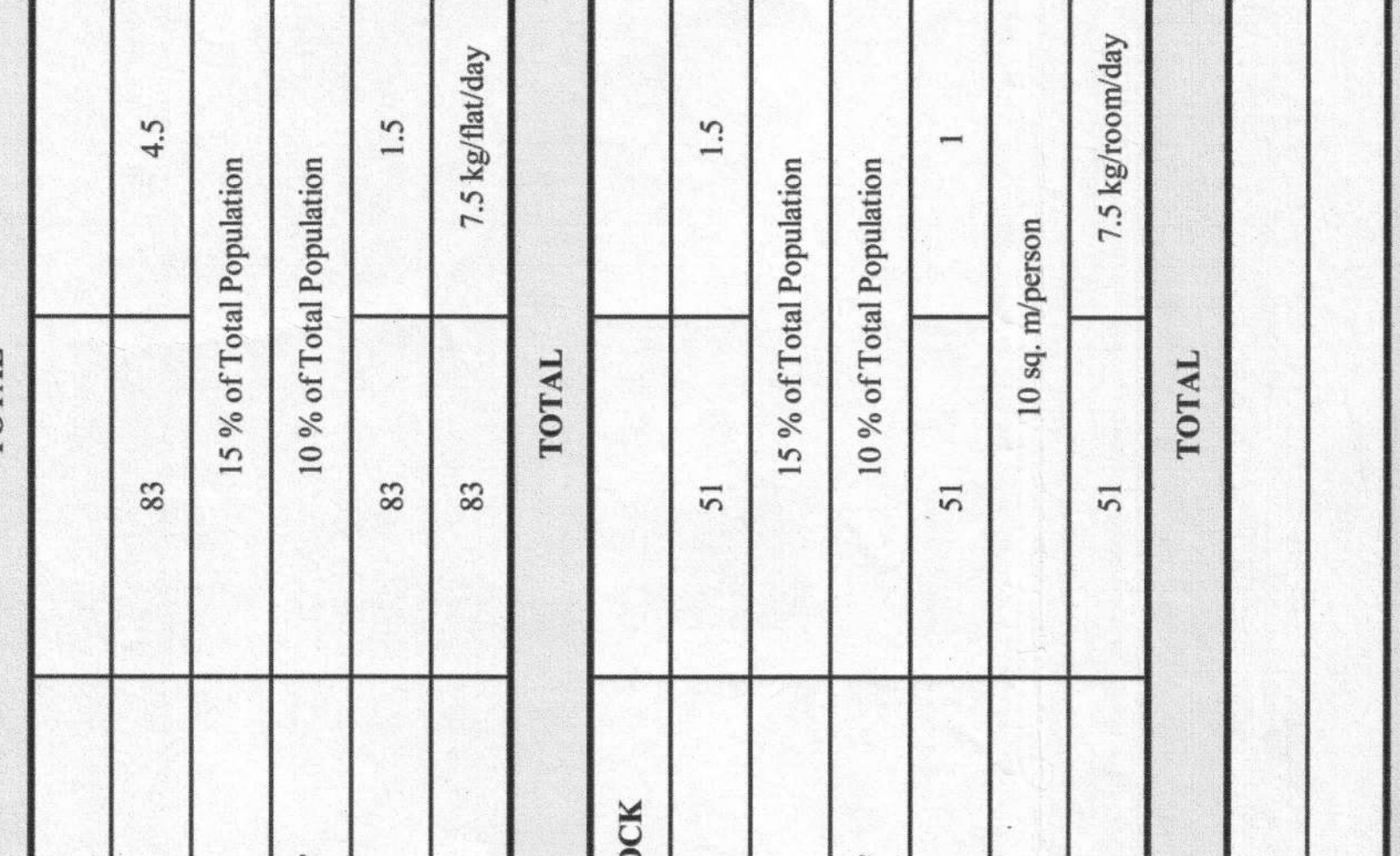
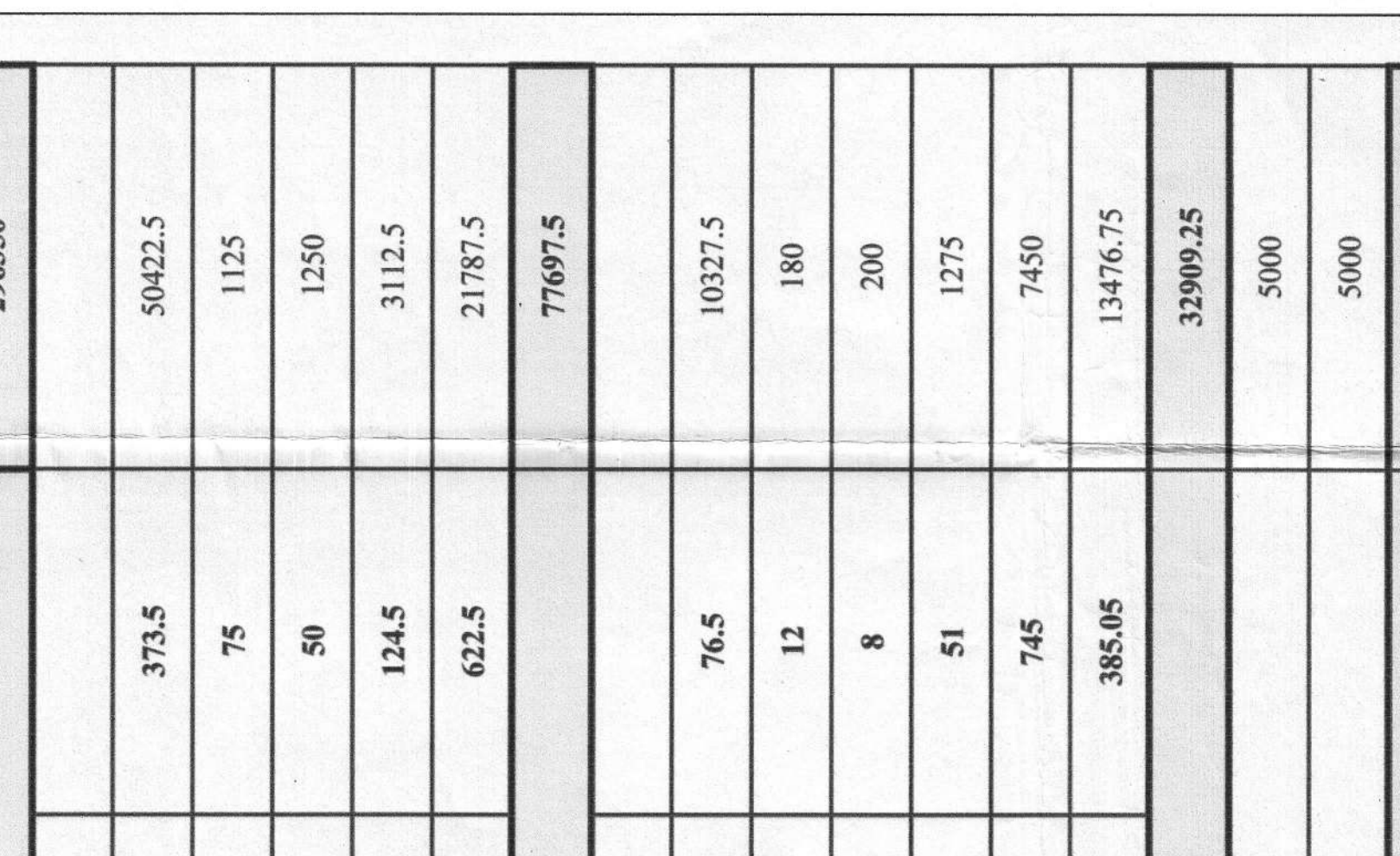
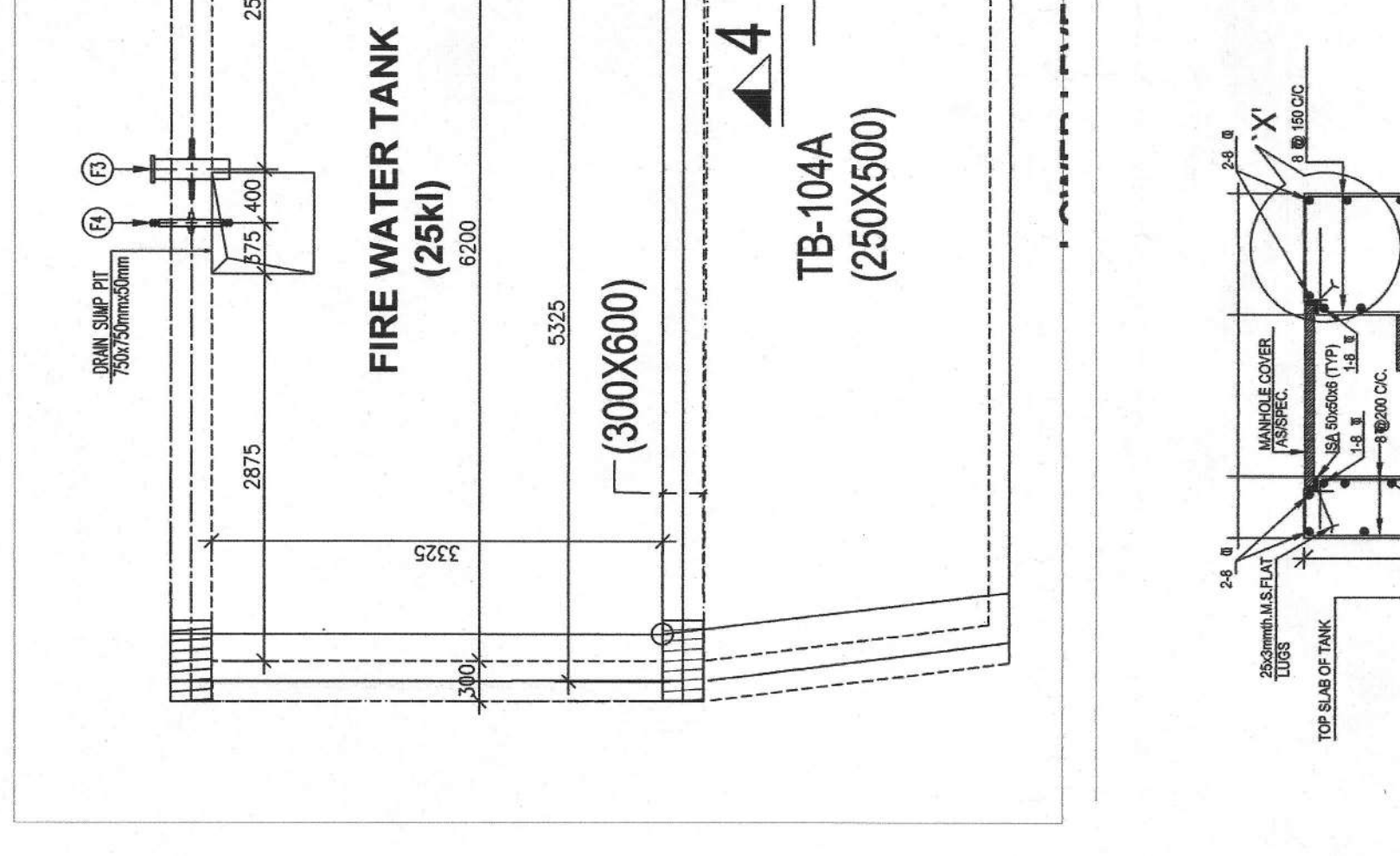
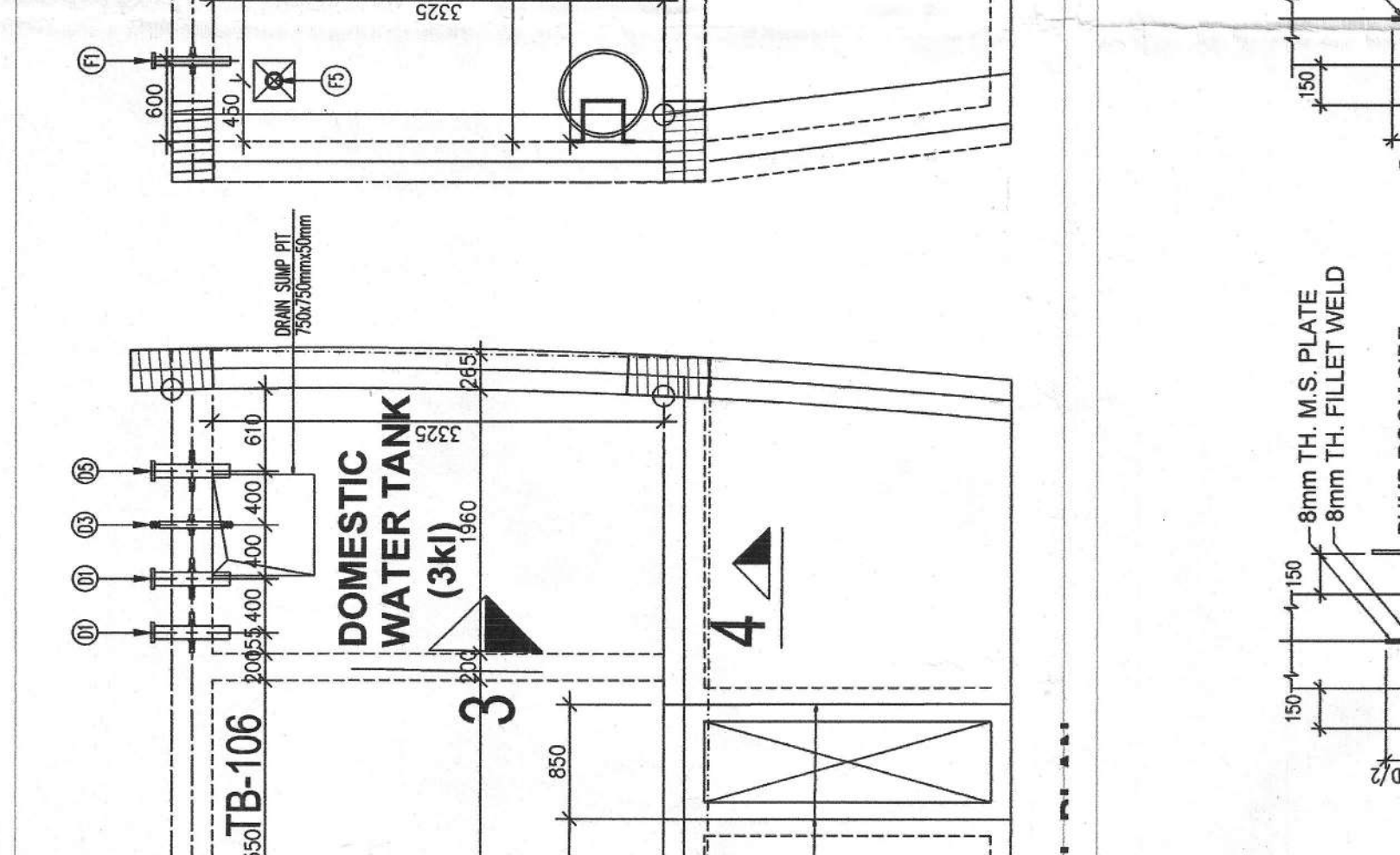
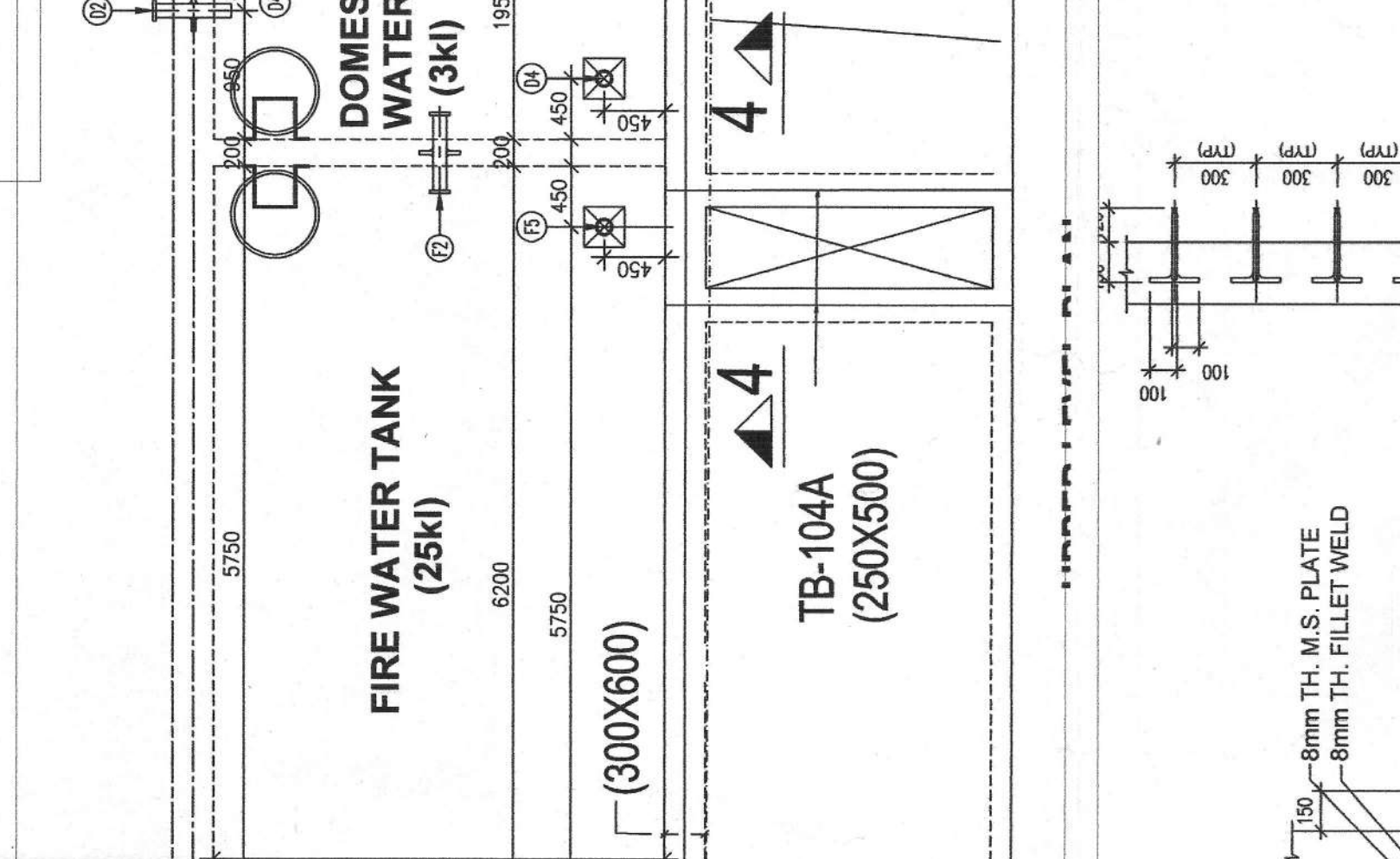
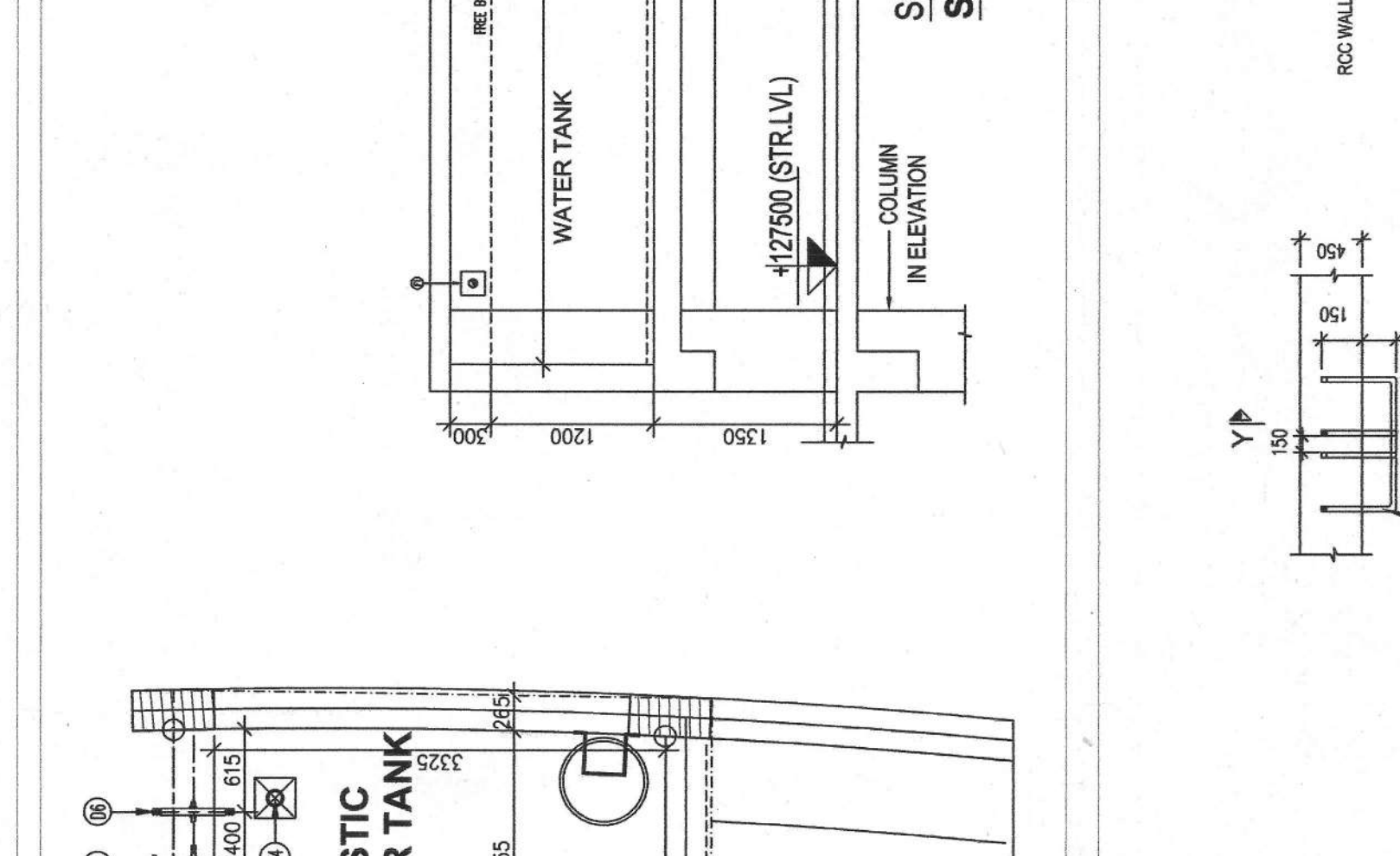
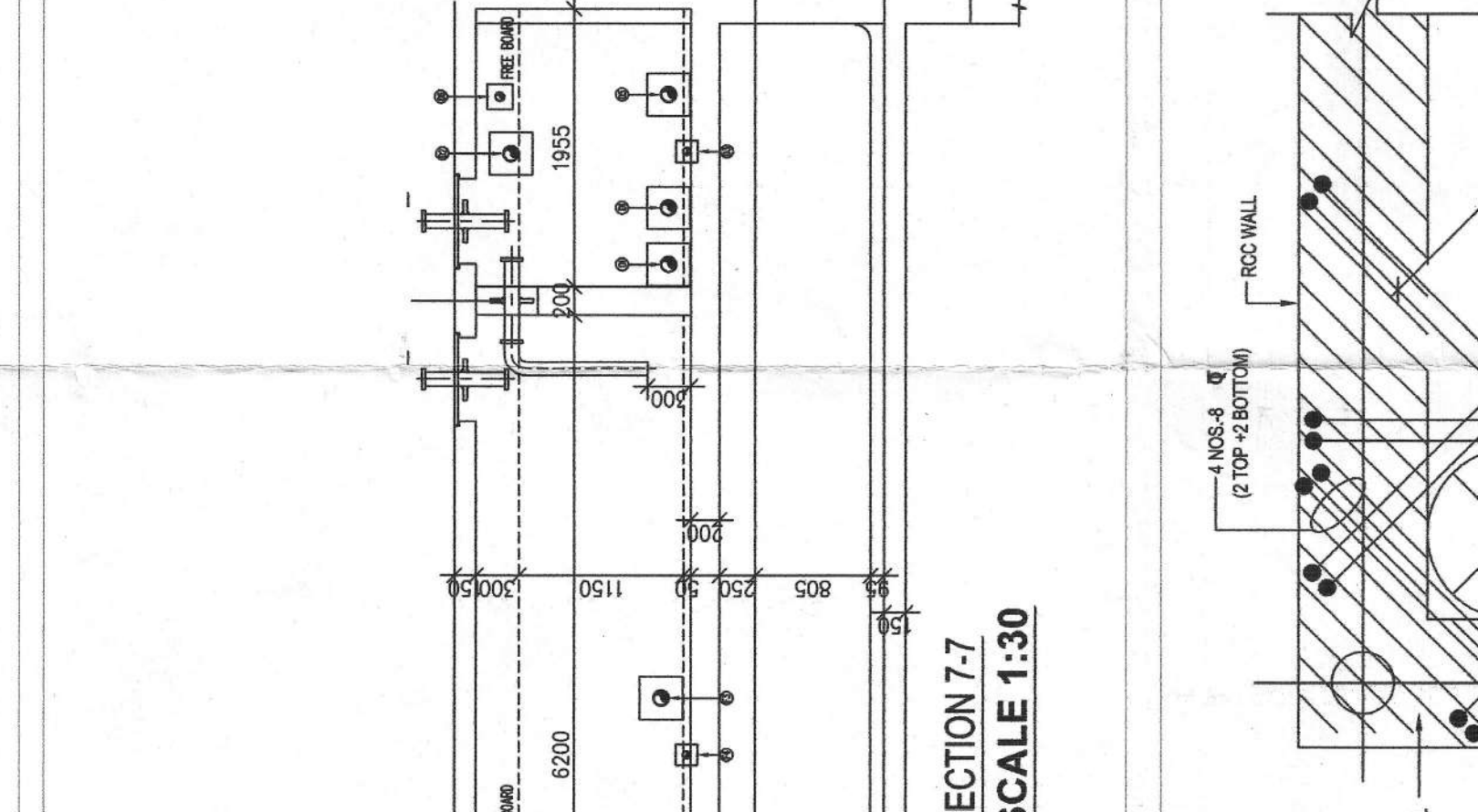
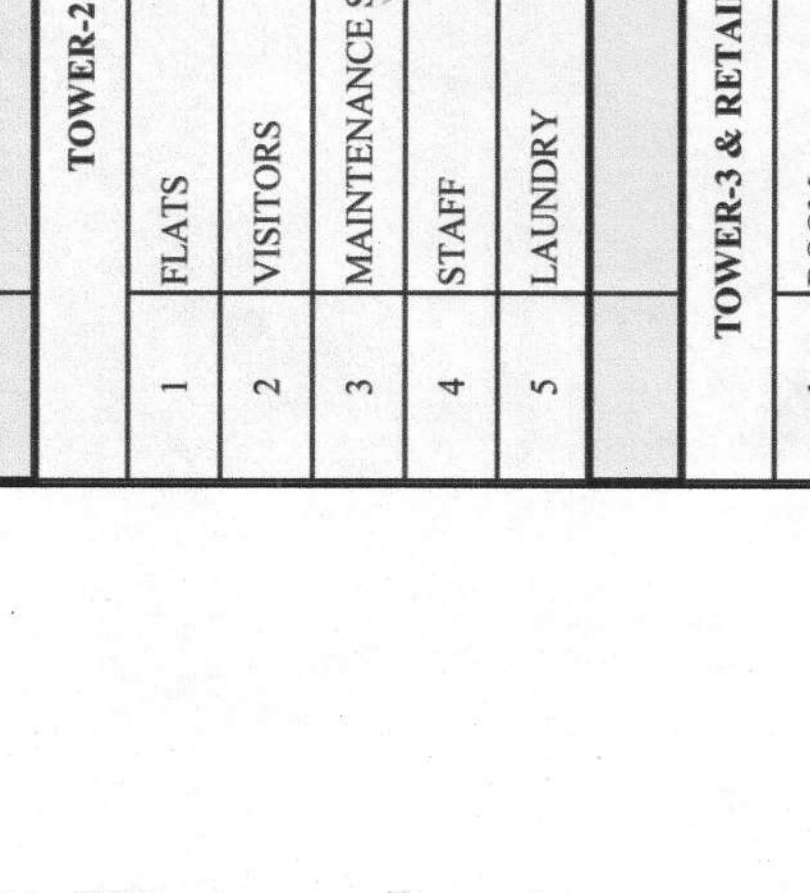
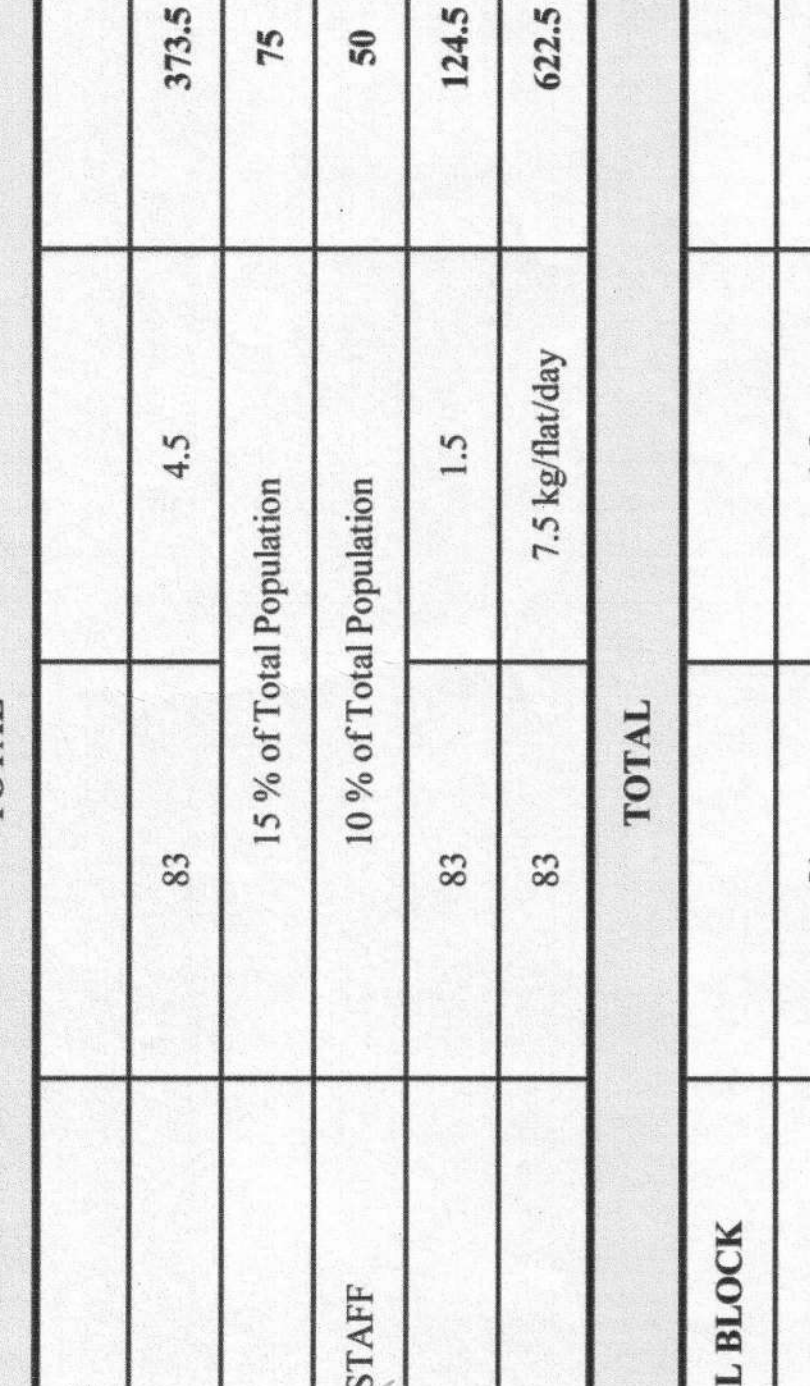
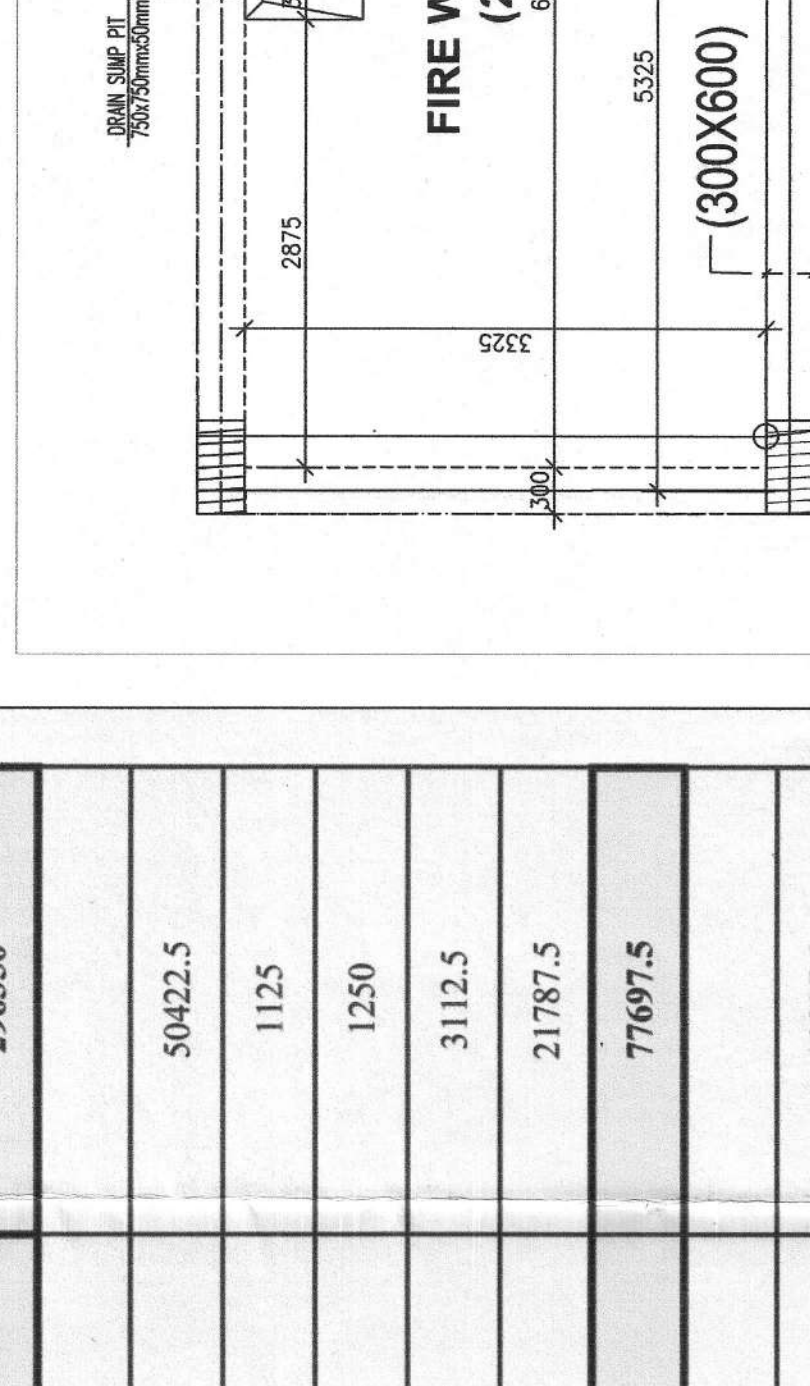
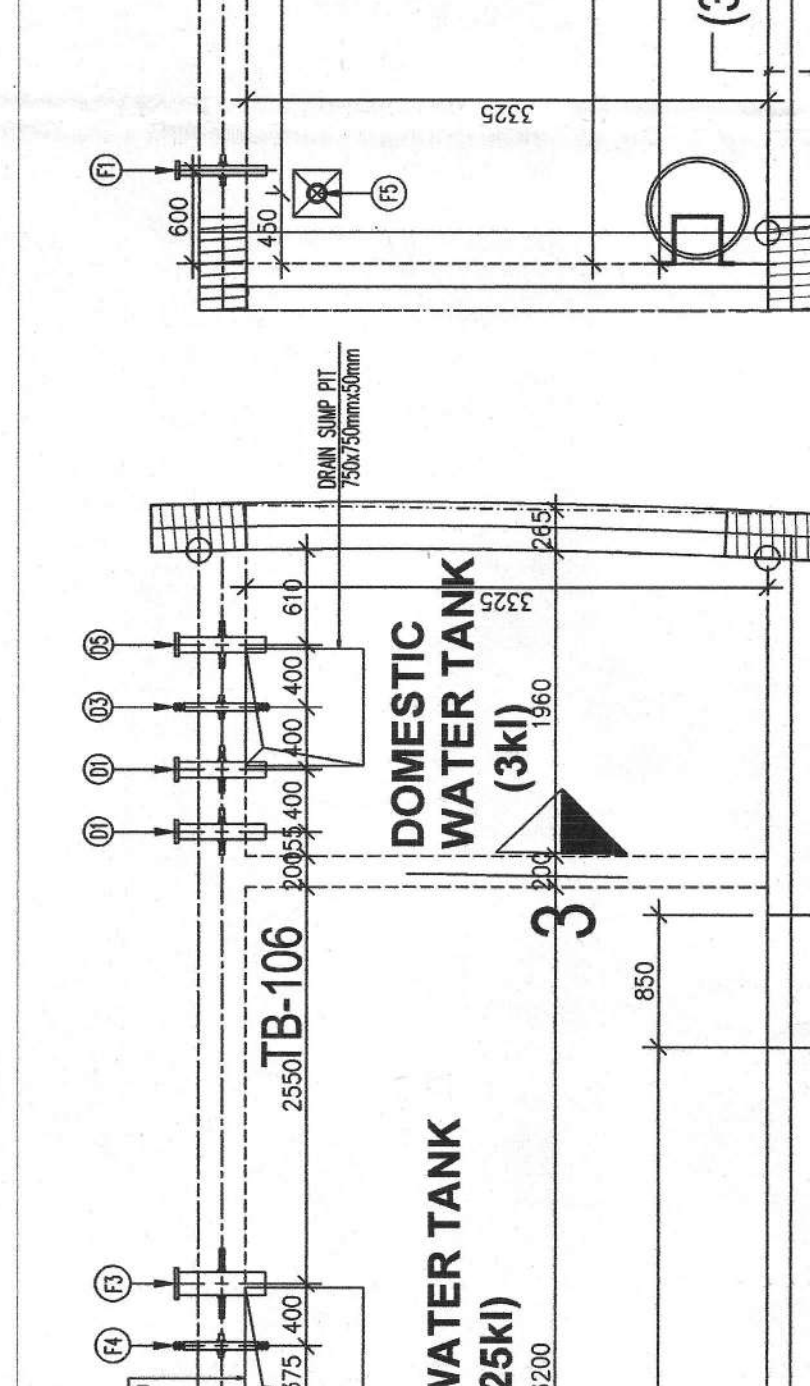
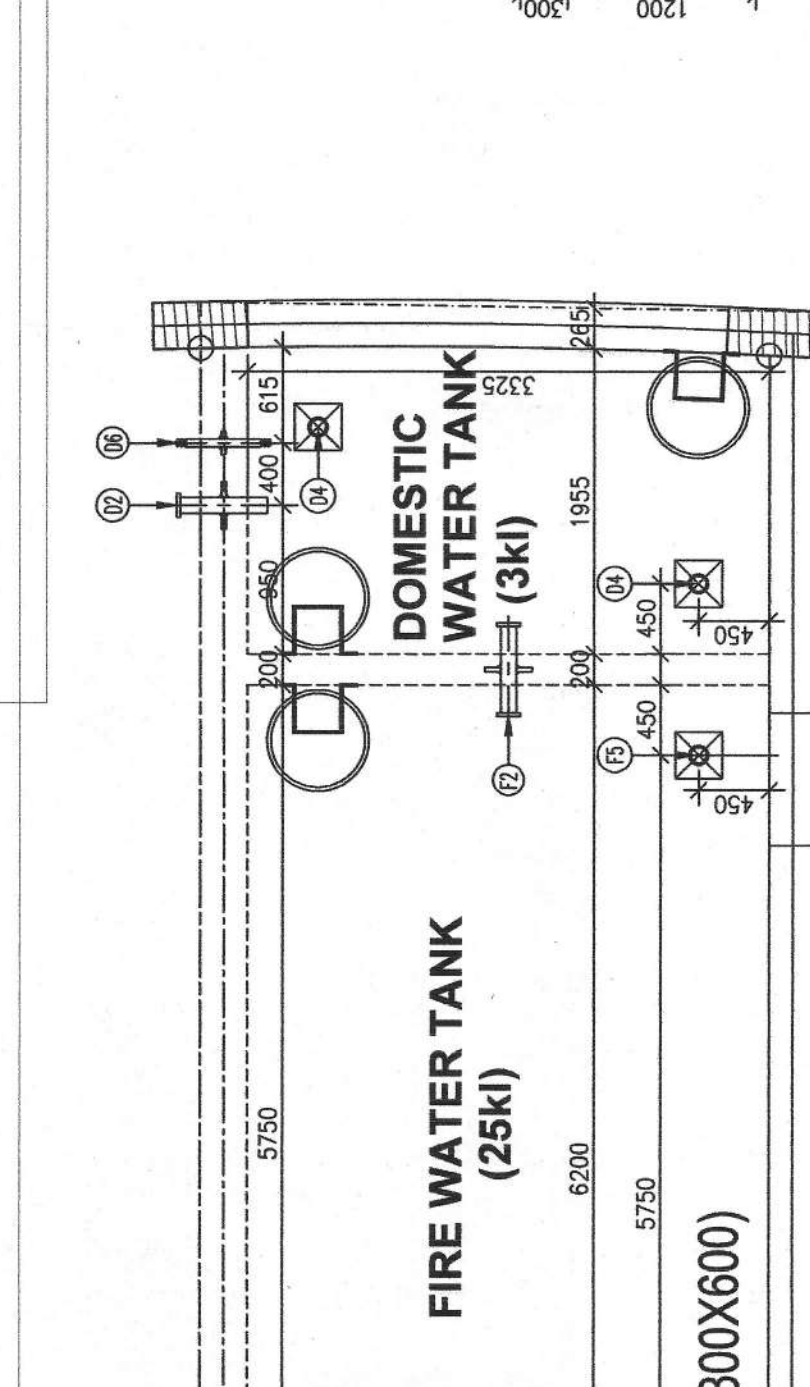
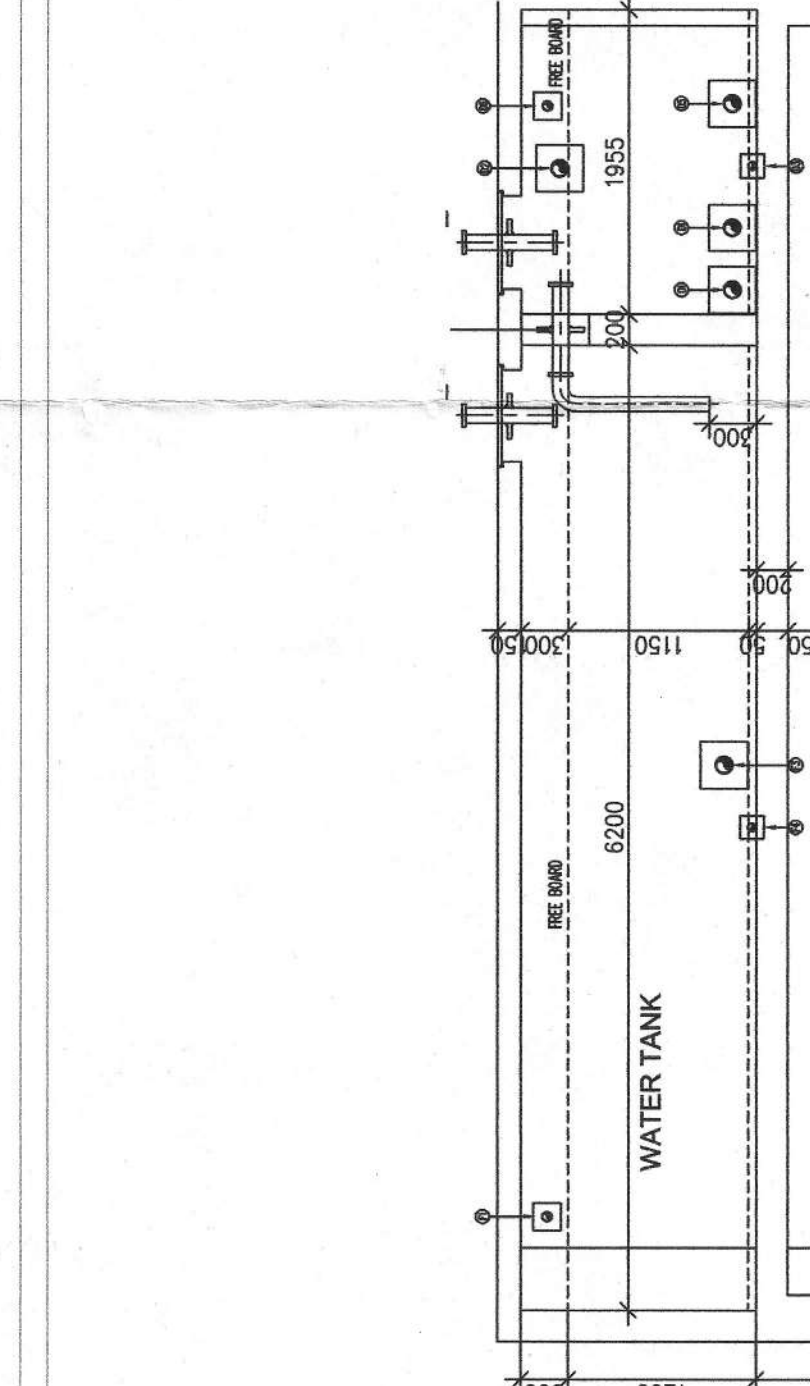

APPLICANT NAME & ADDRESS
SHRISTI INFRASTRUCTURE DEVELOPMENT CORPORATION LTD.
PLOT NO. 22, RAJARHAT, DIST. SOUTH 24 PARGANAS, DIST. RAJARHAT-700101

PRINCIPAL ARCHITECT
CP Kulego Associates
Address: Plot No. 1001, Green Park
Phone: 26663933, Fax: 1-26663770
E-mail: cpko@cpkulego.com

CERTIFICATE OF THE ARCHITECT
I hereby certify that the drawings have been prepared under my supervision and to the best of my knowledge and belief they conform to the requirements of the Building Regulations and the conditions of the contract for the construction of the building and I am not aware of any violation of provisions of these rules and the provisions of the Act and also certified that the building is safe and stable in all respects and these provisions shall be adhered to during the construction.

CERTIFICATE OF STRUCTURAL ENGINEER
I hereby certify that the design and construction of the structure is in accordance with the provisions of the Indian Standard and National Building Code of India and I am not aware of any violation of provisions of these rules and the provisions of the Act and also certified that the building is safe and stable in all respects and these provisions shall be adhered to during the construction.

CERTIFICATE OF GEO-TECHNICAL ENGINEER
It is certified that the comprehensive Geo-technical Report on soil investigation has been prepared by me for design and construction of the foundation of the building and I am not aware of any violation of provisions of these rules and the provisions of the Act and also certified that the foundation of the structure will be constructed in accordance with the provisions of the Act and also certified that the building is safe and stable in all respects and these provisions shall be adhered to during the construction.

TITLE: SERVICE DRAWING
OVERHEAD & UNDER GROUND WATER TANK WITH WATER DEMAND CALCULATION

DATE: 10.04.2017
SCALE: 1:20
(UNLESS OTHERWISE MENTIONED)

